

- FIXING CARPENTER NOTE:**
- PROVIDE SHELF & RAIL @ 1650 AFL TO ALL ROBES NOTED S & R.
 - PROVIDE 4 SHELVES TO LINEN & PTY WHERE NOTED 4 x SH.
 - PROVIDE SHELF SUPPORT WHEN SPAN EXCEEDS 1800mm U.N.O.

- PLAN LEGEND**
- ⊕ EXHAUST FAN - CEILING MOUNTED (FLUMED TO EXTERNAL AIR)
 - ⊙ DIRECT WIRED INTERCONNECTED SMOKE DETECTOR TO A.S. 3786-2014
 - ⊖ CEILING VENT - UNFLUMED

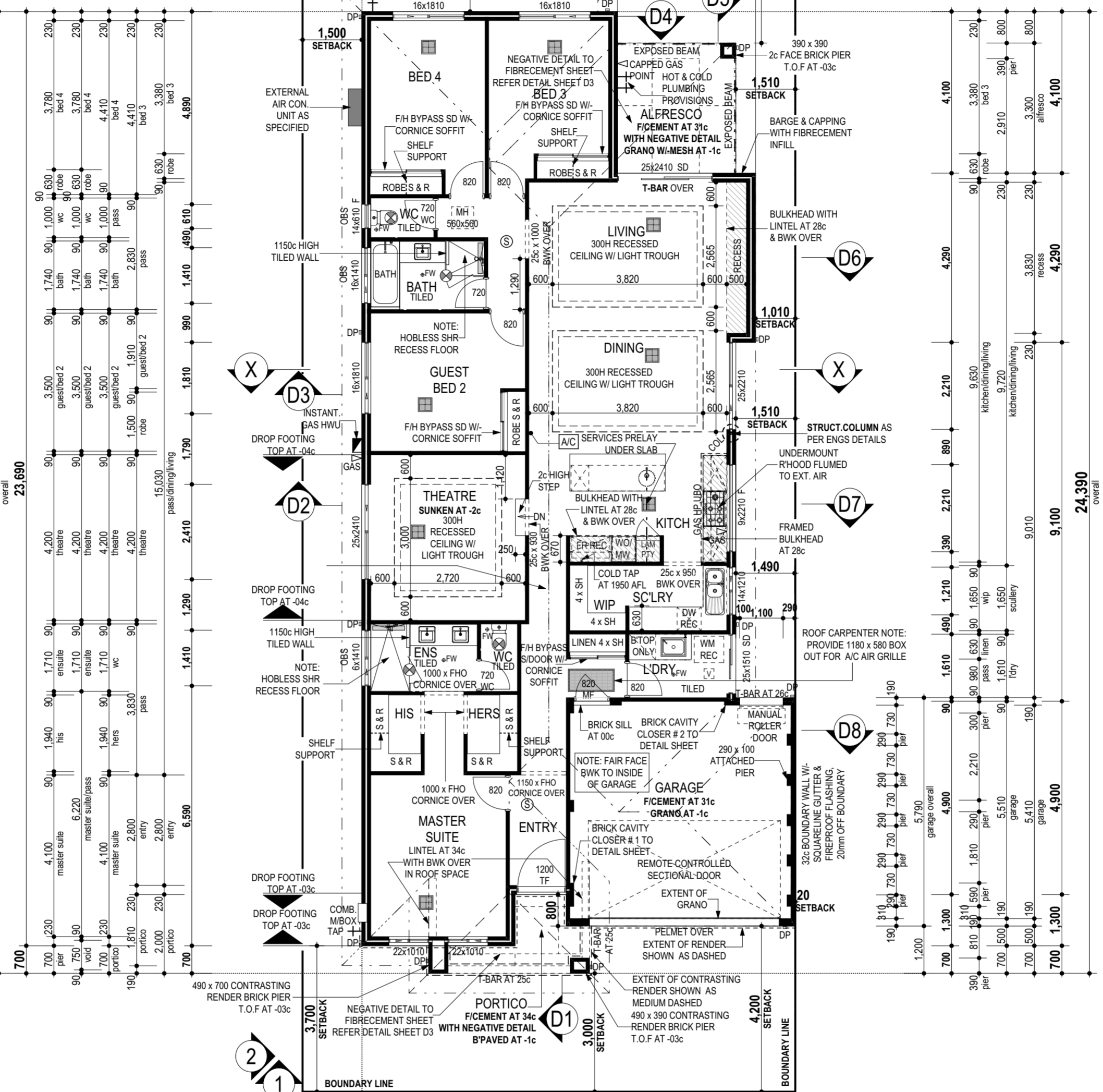
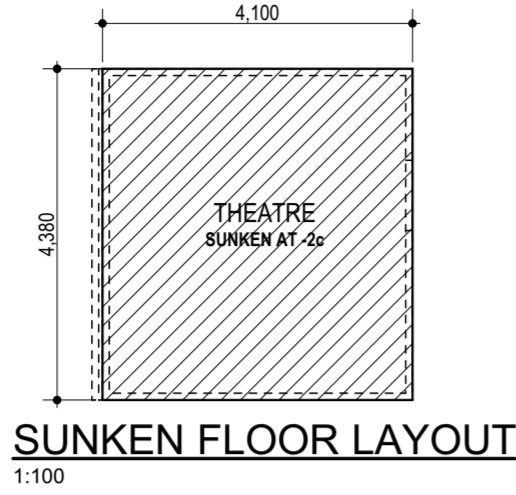

Floor Areas			
Floor	Area	Area	
GROUND FLOOR			
HOUSE	186.75		
GARAGE	32.70		
ALFRESCO	9.90		
PORTICO	4.84		
	234.19 m²		
Perimeters			
Floor	Area	Perimeter	
GROUND FLOOR			
HOUSE		67.36	
Roof Areas			
Floor	Pitch	Flat	Pitched
GROUND FLOOR ROOF			
	24.43°	258.82	284.78
		258.82 m²	284.78 m²

- CEILING NOTE:**
- CEILINGS AT 31c + PLATE UNLESS NOTED OTHERWISE

- BUSHFIRE REQUIREMENTS NOTE:**
- CONSTRUCTION TO COMPLY WITH BAL 12.5, REFER TO DETAILS SHEET, ADDENDA, AS3959 & NCC REQUIREMENTS.

- AIR-CON. LEGEND**
- ⊕ A/C CONTROL PAD (W/ 25mm CONDUIT WHEN ON INTERNAL WALL)
 - ⊖ RETURN AIR GRILLE
 - ⊙ CEILING VENT
 - ⊖ OUTDOOR MOTOR

- NOTE:**
- PROVIDE DUCTED REVERSE CYCLE AIR-CON SYSTEM. POSITION OF VENTS, WALL AND ZONE CONTROLLER TO BE CONFIRMED AT PRESTART STAGE.

- SUPERVISOR / TRADES NOTE:**
- REFER TO ENGINEERS DRAWINGS FOR SIZES & LOCATIONS OF ALL STRUCTURAL COLUMNS, PWP'S AND BEAMS.

- OWNER NOTE:**
- DUE TO ONGOING CHANGES TO STATUTORY REQUIREMENTS AND BUILDING METHODS, SOME ASPECTS OF THIS BUILDING MAY BE AT VARIANCE TO THE ORIGINAL DISPLAY VERSION (IF APPLICABLE).
 - WHERE PRELIMINARY DRAWINGS ARE PROVIDED BY THE OWNER OR THE OWNER'S AGENT, THE BUILDER RESERVES THE RIGHT TO MODIFY THE OWNERS DRAWINGS TO SUIT THE BUILDER'S CURRENT CONSTRUCTION METHOD.

FLOOR PLAN

1:100

- PLUMBER NOTE:**
- PROVIDE REFLUX VALVE TO SEWER LINE.

- NOTE:**
- DO NOT SCALE FROM DRAWINGS.
 - VERTICAL BRICK COURSE HEIGHTS ARE RELATED TO STANDARD BRICK SIZES.
 - ALL INTERNAL DIMENSIONS ARE TO BRICK SIZES, NOT FINISHED SIZES.
 - THE CONSTRUCTION DETAILS REFERRED TO IN THESE DOCUMENTS DO NOT FORM PART OF THE CONTRACT DOCUMENTS & MAY BE CHANGED AT ANY TIME WITHOUT NOTICE, AT THE BUILDER'S DISCRETION.
 - PROVIDE INSULATION TO HOUSE CEILINGS AS PER ADDENDA.
 - LOCATION OF DOWN PIPES IS INDICATIVE ONLY & MAY BE CHANGED AT BUILDERS DISCRETION AND MUST COMPLY WITH TOP 3.5.2 VOLUME 2 OF THE NCC.
 - TOP OF FOOTINGS FOR PIER/POSTS TO CARPORT, VERANDAH & PORCH ARE TO BE 2c BELOW FINISHED PAVING LEVEL UNLESS NOTED OTHERWISE.
 - ALL DRAWINGS TO BE READ IN CONJUNCTION WITH ENGINEER'S DRAWINGS.
 - TIMBER FRAMING TO A.S. 1684
 - 'WC' DENOTES LIFT-OFF HINGES.
 - PROVIDE CORNER BEADS INTERNALLY TO ALL EXTERNAL CORNERS EXCLUDING DOOR & WINDOW REVEALS.

Plunkett Homes

129 Hasler Road, Osborne Park, W.A. 6017.
 PO Box 55, Westfield Shopping Centre, Innaloo, W.A. 6918.
 Ph 08 9366 0000.
 Fx 08 9258 4088.
 www.plunketthomes.com.au
 Reg. Builder No. 7995, A.B.N. 98 009 250 373

REV	VO #	DRN	DATE	CHK
01	Doc #1	HBH	25/11/20	NS
02	ENGINEERS	HBH	10/03/21	HBH
03	Doc #4	HBH	29/03/21	HBH
04	DOC NO. 3	NS	12/04/21	NS
05	DOC NO. 5	NS	16/04/21	NS
06	Doc 08	AB	17/05/21	AB
07	DOC #11	HBH	13/01/22	HBH

WORKING DRAWINGS
 THIS IS ONE OF THE DRAWINGS REFERRED TO IN THE CONTRACT.
 DATED:...../...../.....

OWNER..... WITNESS.....
 OWNER..... WITNESS.....
 BUILDER..... WITNESS.....

ADDRESS:
 LOT 285
 WATEROUS STREET
 PIARA WATERS

SPECIAL E & OE

MODEL N°..... LUXE SPECIFICATION DATE 13/01/22

© COPYRIGHT

SHEET N° 02 OF 6 + 6 ANC

JOB N° 40994

REVISION 07